

# Contour Hardware installed Prior to 1989

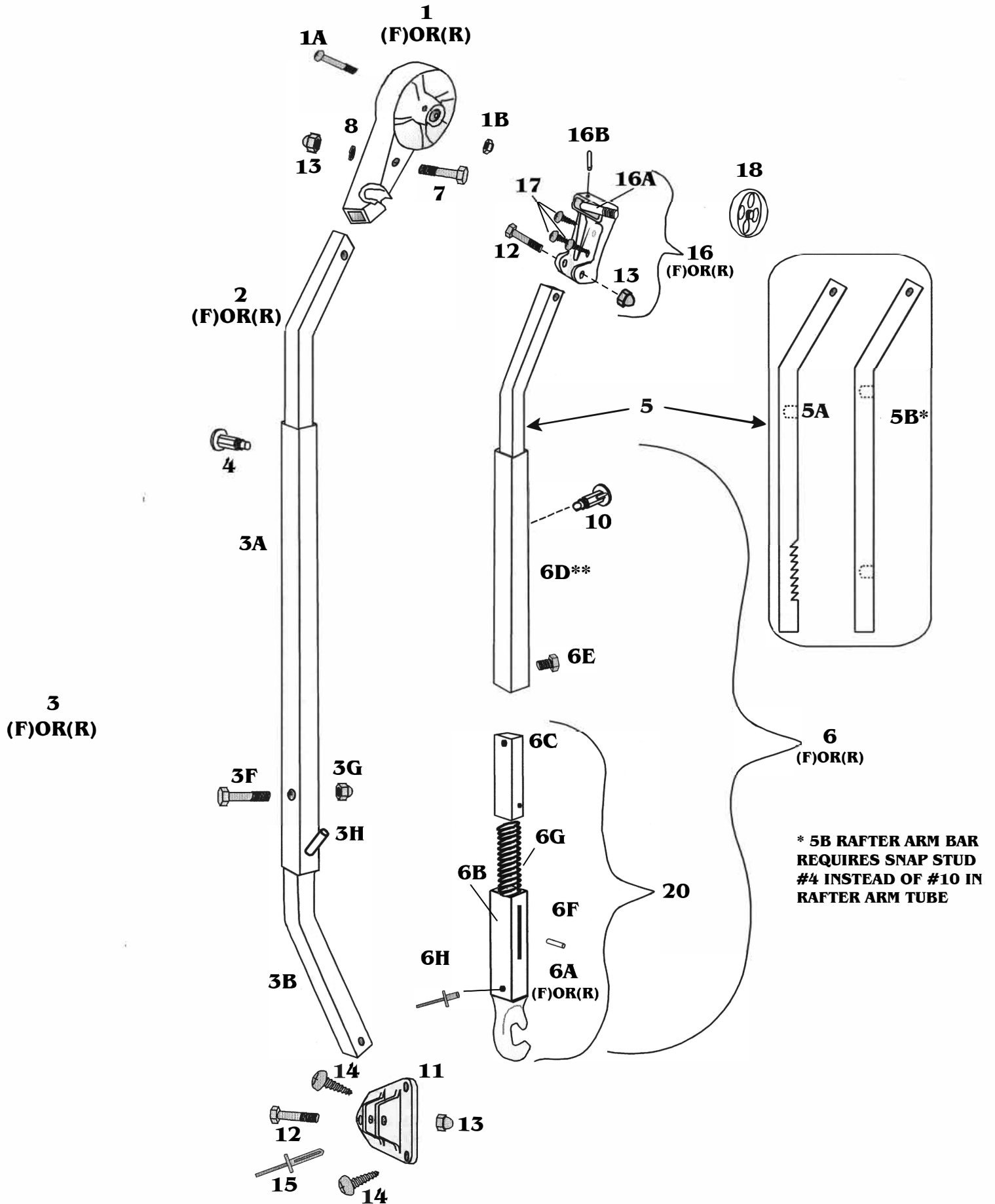

Ref #	PART #	CONTOUR HARDWARE installed Prior to 1989
1	21012F/R-XXX	<b>HEAD CASTING, CONTOUR, FRONT/REAR (red logo), includes:</b>
1A	317212	BOLT, 10/32 x 1-1/2", HARDENED STEEL
1B	311070	NUT, 10/32, NYLOCK HEX (stainless)
2	21300F/R-XXX	FRONT/REAR MAIN ARM BAR (stainless)
3	21100F/R-XXX	<b>BRIGHT '88 FRONT/REAR MAIN ARM TUBE ASSEMBLY, includes:</b>
3A	211000-XXX	BRIGHT '88 MAIN ARM TUBE ONLY
3B	211300-XXX	BRIGHT '88 HINGE BAR
3F	310040	BOLT, 1/4 - 20 X 1-1/4", HEX HEAD
3G	311020	CAP NUT, 1/4 - 20 (aluminum)
3H	313180	CLAW PIN
4	290002	SNAP STUD ASSEMBLY
5A	214000-XXX	BRIGHT '78 -'88 RAFTER ARM BAR, (ratchet)
5B	214200-XXX	BRIGHT '65 -'77 RAFTER ARM BAR (two holes only)
6	21250F/R-XXX	<b>BRIGHT FRONT/REAR RAFTER ARM TUBE ASSEMBLY, includes:</b>
6A	210190	FRONT CLAW CASTING
6A	210200	REAR CLAW CASTING
6B	21260F/R-XXX	BRIGHT '88 FRONT/REAR SLOTTED CLAW TUBE ONLY
6C	212910-XXX	BRIGHT '88 STUB BAR, 4-3/4"
6D	212000	BRIGHT '88 RAFTER ARM TUBE ONLY
6E	310060	BOLT, 1/4 - 20 X 5/8", HEX HEAD
6F	313220	GUIDE PIN, 1/8 X 5/8
6G	322110	COMPRESSION SPRING, 4-1/4"
6G	322100	COMPRESSION SPRING, 6-3/4"
6H	316100	RIVET, 5/32, BLIND (stainless)
10	290001	RATCHET STUD ASSEMBLY
20	21270F/R-XXX	BRIGHT FRONT/REAR CLAW TUBE/BAR ASSEMBLY
11	210050	BASE HINGE, TRIANGULAR (rib mount)
16	210121	FRONT CURVED CLAMP ASSEMBLY, includes:
16A	325110	THREADED STUD, 3/8 - 16
16B	313040	DRIVE PIN, 1 X 1/8
16	210122	REAR CURVED CLAMP ASSEMBLY, includes above
18	210390	CLAMP WHEEL
	299000-XXX	<b>CONTOUR HARDWARE MOUNTING KIT, includes:</b>
7	310030	(2) BOLT, 1/4 - 20 X 1-3/8", HEX HEAD
8	312010	(2) LOCKWASHER, 1/4" (stainless)
12	310010	(4) BOLT, 1/4 - 20 X 1-5/8", HEX HEAD
13	311010	(6) NUT, 1/4 - 20, ACORN CAP (stainless)
14	317050	(4) SCREW, 14 X 1", PAN HEAD
15	316030	(2) RIVET, 3/16 X 1", OLYMPIC
17	317030	(6) SCREW, 10 X 3/4", PAN HEAD
	1HD10F/R-XXX	BRIGHT HALF SET OF HARDWARE, FRONT/REAR

(XXX) - YEAR, MAKE, MODEL OF COACH REQUIRED

